

**Sonneborn®****Concrete  
Repair  
Systems****SONOCRETE®****SONOPLUG™****Quick-setting hydraulic cement repair mortar for stopping leaks****Features**

- Quick setting...
- Fully hydraulic...
- Nonmetallic...
- Requires no special tools...
- Shrinkage compensated...
- Mixes with water only...

**Benefits**

- Stops active water flow
- Minimizes down time
- Sets above or below water
- Cannot rust
- Easy to use
- Expands to lock in place
- Strong, economical repairs

**Where to Use  
Sonoplug™**

Stops leakage and seepage through

- Masonry
- Concrete floors
- Above and below grade
- Walls
- Junctions
- Around inserts like sleeves and pipes
- Holes, static cracks, faults

**How to Apply Sonoplug™****Surface Preparation**

- 1 Area to be plugged must be cleared of any loose or unsound concrete, mortar, and debris using a wire brush or suitable tools.
- 2 For best results, if depression is less than 3/4" (19 mm) in width or depth, chisel to this dimension with bottom wider than surface. See diagram below.

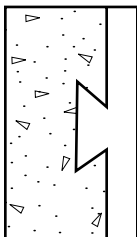

- 3 Flush with clean water.
- 4 If hole or crack is not leaking water at time of repair, dampen area before plugging.

**Mixing**

- 1 Use between 40°F (4°C) and 90°F (32°C).
- 2 Use approximately 3 fl. ounces of potable water per lb. of material (194 ml/kg). Use warm water for cool temperatures and cold water for warm temperatures.
- 3 Mix thoroughly with clean water to a stiff putty-like consistency. Do not overmix. Do not mix more than can be used and put into place in 3 minutes.

**Application****Stopping running water**

- 1 Do not place Sonoplug™ into the opening immediately; hold it in one hand or on a trowel until product starts to slightly stiffen, then press firmly into the hole or crack, starting at the top.
- 2 Maintain pressure on the patch for approximately 3 to 5 minutes until the material hardens.
- 3 After any active water has been stopped, cut excess patch even with surrounding walls for a proper finish without damaging the plug.

**Sealing cracks in walls and floors**

- 1 Force Sonoplug™ into the prepared crack with trowel or putty knife. Do not twist or overwork.
- 2 Smooth out to form the desired finish. Apply subsequent coating(s) once Sonoplug™ has sufficiently hardened and dried.

**Clean Up**

Clean all tools with soap and water immediately after use. Cured material can be removed by mechanical means only.

**For Best Performance**

- Do not retemper.
- High temperatures accelerate set, low temperatures retard set.
- Do not fill voids greater than 30 cubic inches (490 cm<sup>3</sup>) in one lift.
- Not to be used as a load-bearing patching material.
- Not intended for overhead or vertical anchoring.
- Make certain the most current version of this data guide is being used; call Customer Service (1-800-433-9517) to verify the most current version.
- Proper application is the responsibility of the user. Field visits by ChemRex® personnel are for the purpose of making technical recommendations only and are not for supervising or providing quality control on the jobsite.

## Technical Data

Compressive strength (ASTM C 109)	psi (MPa)
1 hour	2,000 (13.8)
28 days	5,500 (37.9)

Flexural strength (ASTM C 348)	psi (MPa)
7 days	600 (4.1)

Tensile strength (ASTM C 190)	psi (MPa)
7 days	300 (2.1)

Test results are averages obtained under laboratory conditions. Reasonable variations can be expected.

## Order Information

### Packaging

Sonoplug™

- 10 lb. (4.54 kg) cans, 4 cans per carton
- 50 lb. (22.7 kg) pails

Shelf life is typically 1 year when stored in unopened containers under normal conditions.

### Coverage

- When mixed according to directions, 1 lb. (454 g) fills 15 cubic inches (245 cm<sup>3</sup>) or a crack 3/4" (19 mm) by 3/4" (19 mm) by 25" (0.063 m)

## Warning

Sonoplug™ contains calcium hydroxide, calcium carbonate, crystalline silica, Portland cement, calcium aluminate

### Risks

Product is alkaline on contact with water and may cause injury to skin or eyes. Ingestion or inhalation of dust may cause irritation. Contains small amount of free respirable quartz which has been listed as a suspected human carcinogen by NTP and IARC. Repeated or prolonged overexposure to free respirable quartz may cause silicosis or other serious and delayed lung injury.

## Precautions

KEEP OUT OF THE REACH OF CHILDREN. Avoid contact with skin, eyes and clothing. Prevent inhalation of dust. Wash thoroughly after handling. Keep container closed when not in use. DO NOT take internally. Use only with adequate ventilation. Use impervious gloves, eye protection and if the TLV is exceeded or if used in a poorly ventilated area, use NIOSH/MSHA approved respiratory protection in accordance with applicable federal, state and local regulations.

## First Aid

In case of eye contact, flush thoroughly with water for at least 15 minutes. In case of skin contact, wash affected areas with soap and water. If irritation persists, SEEK MEDICAL ATTENTION. Remove and wash contaminated clothing. If inhalation causes physical discomfort, remove to fresh air. If discomfort persists or any breathing difficulty occurs or if swallowed, SEEK IMMEDIATE MEDICAL ATTENTION.

Refer to Material Safety Data Sheet (MSDS) for further information.

## Proposition 65

This product contains materials listed by the state of California as known to cause cancer, birth defects, or reproductive harm.

### VOC Content

0 g/L or 0.00 lbs./gal. less water and exempt solvents.

**For medical emergencies only, call ChemTrec (1/800/424-9300).**

### Limited Warranty Notice

Every reasonable effort is made to apply ChemRex® exacting standards both in the manufacture of our products and in the information which we issue concerning these products and their use. We warrant our products to be of good quality and will replace or, at our election, refund the purchase price of any products proved defective. Satisfactory results depend not only upon quality products, but also upon many factors beyond our control. Therefore, except for such replacement or refund, CHEMREX® MAKES NO WARRANTY OR GUARANTEE, EXPRESS OR IMPLIED, INCLUDING WARRANTIES OF FITNESS FOR A PARTICULAR PURPOSE OR MERCHANTABILITY, RESPECTING ITS PRODUCTS, and CHEMREX® shall have no other liability with respect thereto. Any claim regarding product defect must be received in writing within one (1) year from the date of shipment. No claim will be considered without such written notice or after the specified time interval. User shall determine the suitability of the products for the intended use and assume all risks and liability in connection therewith. Any authorized change in the printed recommendations concerning the use of our products must bear the signature of the ChemRex® Technical Manager.



**Sonneborn®**

**ChemRex®**

Corporate Office:

889 Valley Park Drive, Shakopee, MN 55379

Customer Service: 1/800/433-9517

Technical Services: 1/800/ChemRex (1/800/243-6739)

Web Site: [www.chemrex.com](http://www.chemrex.com)